

# FOR LEASE

## *1,286± Sq. Ft. Office Space*



### *433 2nd Street, Suite 103 • Woodland, CA*

Large Professional Office Space  
3 Private Offices, Reception, Copy Room & Break Room  
Located in the Garden Court Building  
One block south of Main Street  
Walking distance to restaurants and shopping  
Close to Yolo County Superior Courthouse & Yolo County Offices  
Easy access to/from I-5 & Hwy 113  
Zoning: Central Business District (CBD)  
Lessor pays water/sewer and garbage  
Tenant to pay Landlord \$280/mo PG&E

**Lease Rate: \$1,600.00/mo**

## **S**HEFFIELD **R**EAL **E**STATE

### COMMERCIAL/INDUSTRIAL PROPERTIES

20 N. East Street, Suite 101, Woodland, CA 95776

Phone: (530) 666-5485 Fax: (530) 666-1244

Website: [www.Sheffield-RealEstate.com](http://www.Sheffield-RealEstate.com)

Listing Agent:

CalBRE:

E-Mail:

**Wally Sheffield, Broker**

**01329897**

[sheffieldreca@gmail.com](mailto:sheffieldreca@gmail.com)

# *1,286± Sq. Ft. Office Space*

## *433 2nd Street, Suite 103 • Woodland, CA*



## **SHEFFIELD REAL ESTATE**

**COMMERCIAL/INDUSTRIAL PROPERTIES**

20 N. East Street, Suite 101, Woodland, CA 95776

Phone: (530) 666-5485 Fax: (530) 666-1244

Website: [www.Sheffield-RealEstate.com](http://www.Sheffield-RealEstate.com)

Listing Agent:

CalBRE:

E-Mail:

**Wally Sheffield, Broker**

**01329897**

**[sheffieldreca@gmail.com](mailto:sheffieldreca@gmail.com)**

The information contained herein has been obtained from sources we deem reliable. We cannot, however, assume responsibility for its accuracy.

*1,286± Sq. Ft. Office Space*  
*433 2nd Street, Suite 103 • Woodland, CA*

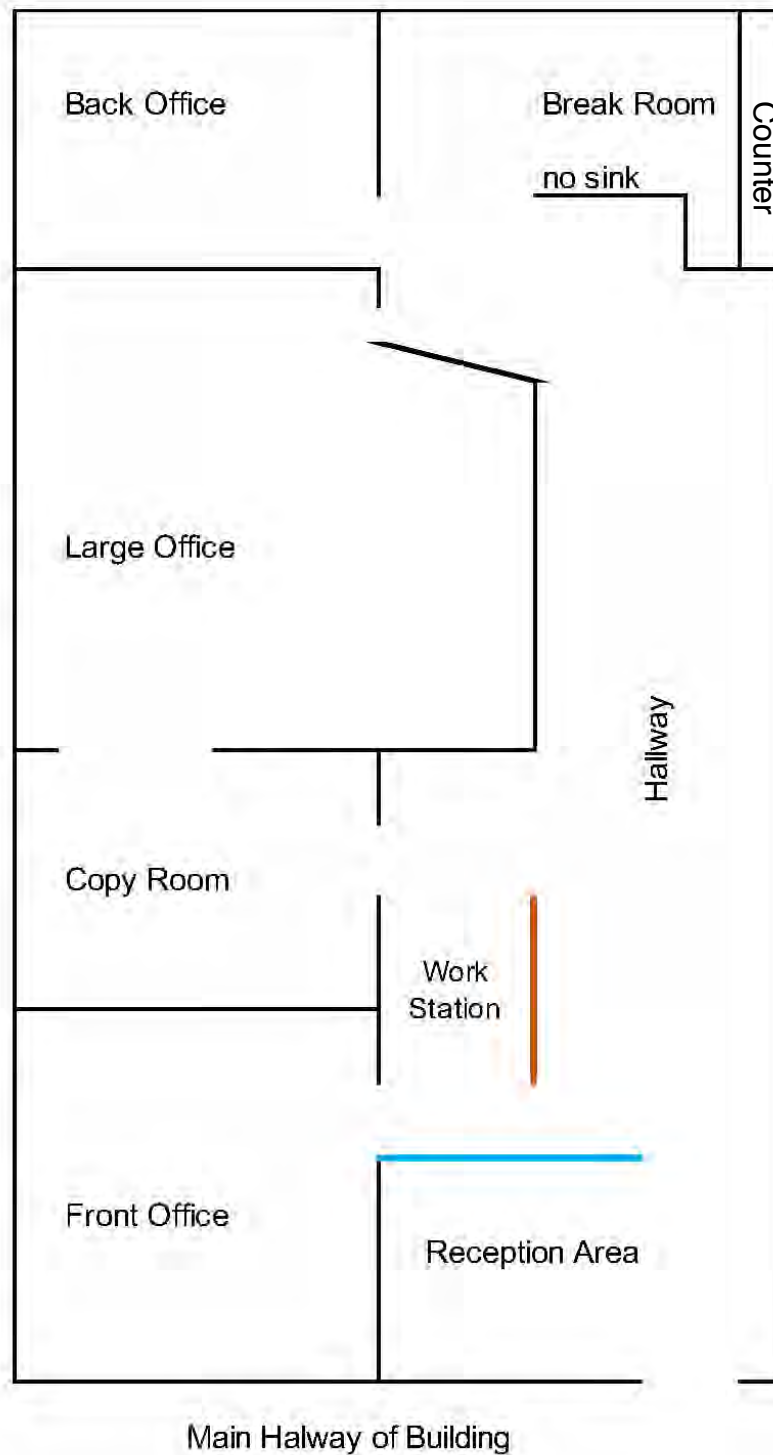

**SHEFFIELD REAL ESTATE**

COMMERCIAL/INDUSTRIAL PROPERTIES  
20 N. East Street, Suite 101, Woodland, CA 95776  
Phone: (530) 666-5485 Fax: (530) 666-1244  
Website: [www.Sheffield-RealEstate.com](http://www.Sheffield-RealEstate.com)

Listing Agent: **Wally Sheffield, Broker**  
CalBRE: **01329897**  
E-Mail: [sheffieldreca@gmail.com](mailto:sheffieldreca@gmail.com)

The information contained herein has been obtained from sources we deem reliable. We cannot, however, assume responsibility for its accuracy.