

# FOR LEASE

## *2,327± Sq. Ft. Retail Space with 1,440± Sq. Ft. Warehouse*



### *420 Grand Avenue • Woodland, CA*

Great Downtown location to start or move your business  
2,327± Sq. Ft. Retail Space with open floor plan  
Enclosed office and 2 restrooms, 12' ceiling and sliding door  
2 HVAC units, 6 car parking lot, plus 1 handicap space  
1,440± Warehouse with 14' ceiling, large rollup door,  
Restroom and Three-phase 220 Electrical  
All on 9,130± Sq. Ft. Lot

**Lease Rate: \$3,700/Month**

## **SHEFFIELD REAL ESTATE**

COMMERCIAL/INDUSTRIAL PROPERTIES

20 N. East Street, Suite 101, Woodland, CA 95776

Phone: (530) 666-5485 Fax: (530) 666-1244

Website: [www.Sheffield-RealEstate.com](http://www.Sheffield-RealEstate.com)

Listing Agent:

CalBRE:

E-Mail:

**Wally Sheffield, Broker**

**01329897**

[sheffieldreca@gmail.com](mailto:sheffieldreca@gmail.com)

The information contained herein has been obtained from sources we deem reliable. We cannot, however, assume responsibility for its accuracy.

**2,327± Sq. Ft. Retail Space with  
1,440± Sq. Ft. Warehouse**

**Grand Avenue**

**Memorial Lane**

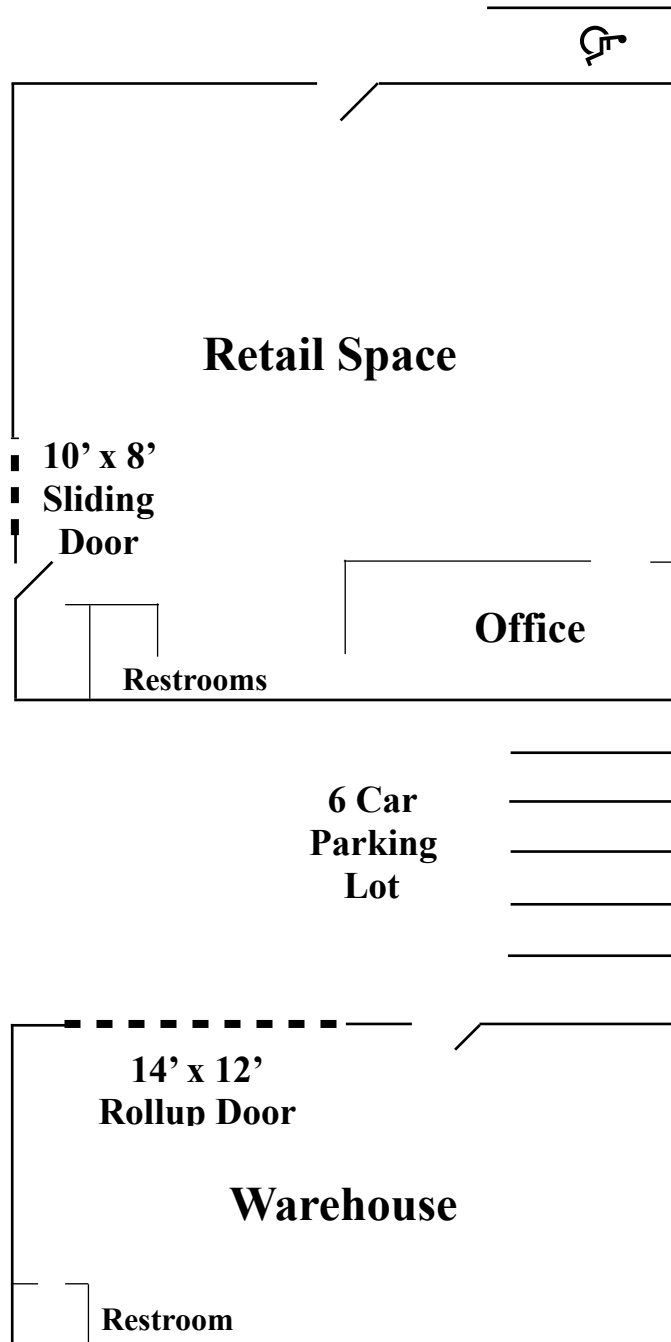

**\*Drawing Not To Scale**

**SHEFFIELD REAL ESTATE**

**COMMERCIAL/INDUSTRIAL PROPERTIES**

20 N. East Street, Suite 101, Woodland, CA 95776

Phone: (530) 666-5485 Fax: (530) 666-1244

Website: [www.Sheffield-RealEstate.com](http://www.Sheffield-RealEstate.com)

Listing Agent:

CalBRE:

E-Mail:

**Wally Sheffield, Broker**

**01329897**

[sheffieldreca@gmail.com](mailto:sheffieldreca@gmail.com)

The information contained herein has been obtained from sources we deem reliable. We cannot, however, assume responsibility for its accuracy.

# 2,327± Sq. Ft. Retail Space with 1,440± Sq. Ft. Warehouse



## SHEFFIELD REAL ESTATE

COMMERCIAL/INDUSTRIAL PROPERTIES

20 N. East Street, Suite 101, Woodland, CA 95776

Phone: (530) 666-5485 Fax: (530) 666-1244

Website: [www.Sheffield-RealEstate.com](http://www.Sheffield-RealEstate.com)

Listing Agent:

CalBRE:

E-Mail:

**Wally Sheffield, Broker**

**01329897**

**[sheffieldreca@gmail.com](mailto:sheffieldreca@gmail.com)**

The information contained herein has been obtained from sources we deem reliable. We cannot, however, assume responsibility for its accuracy.