

# FOR SALE OR LEASE

**9,650± Sq. Ft.**  
**Free Standing Building**



**350 Pioneer Avenue • Woodland, CA**

**Industrial Zoned**  
**Great Location w/ I-5 Visibility**  
**Located just off of the Main Street exit at I-5**

**Asking Price: \$1,100,000**

**Lease Rate: \$0.60/Sq. Ft.**

**AVAILABLE: 07/01/2017**

## **SHEFFIELD REAL ESTATE**

**COMMERCIAL/INDUSTRIAL PROPERTIES**

20 N. East Street, Suite 101, Woodland, CA 95776

E-Mail: [SheffieldRE@pacbell.net](mailto:SheffieldRE@pacbell.net)

Phone: (530) 666-5485 Fax: (530) 666-1244

Website: [www.Sheffield-RealEstate.com](http://www.Sheffield-RealEstate.com)

Listing Agent: **Wally Sheffield, Broker**

E-Mail: [sheffieldre@pacbell.net](mailto:sheffieldre@pacbell.net)

CalBRE Lic: 01329897

The information contained herein has been obtained from sources we deem reliable. We cannot, however, assume responsibility for its accuracy.

# 350 Pioneer Avenue • Woodland, CA

## 9,650± Sq. Ft. Free Standing Building

- 1) Restrooms
- 2) Break Room
- 3) Offices
- 4) Conference Room
- 5) 12' X 12' Roll Up Doors

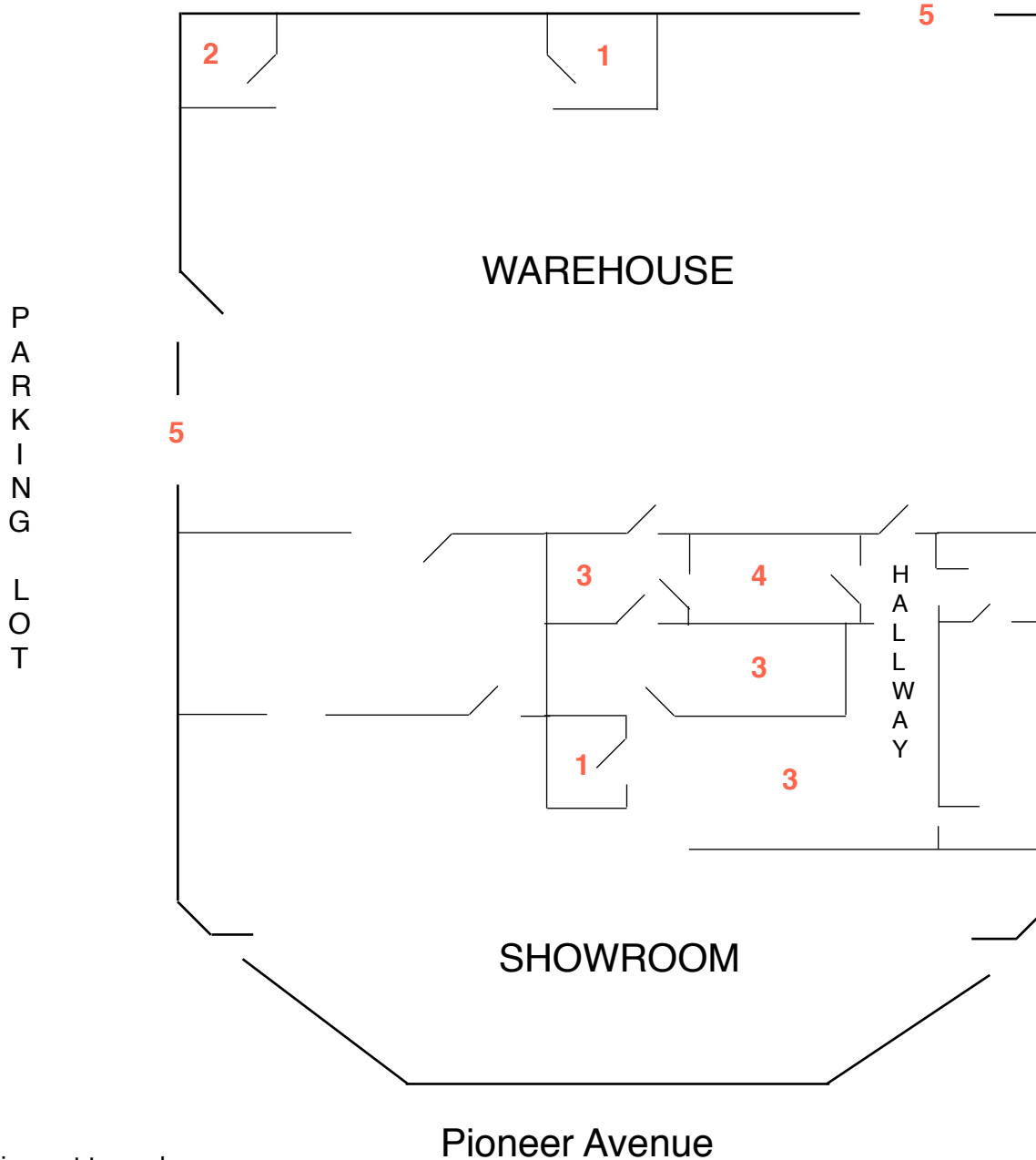

\*Drawing not to scale

## SHEFFIELD REAL ESTATE

### COMMERCIAL/INDUSTRIAL PROPERTIES

20 N. East Street, Suite 101, Woodland, CA 95776

E-Mail: [SheffieldRE@pacbell.net](mailto:SheffieldRE@pacbell.net)

Phone: (530) 666-5485 Fax: (530) 666-1244

Website: [www.Sheffield-RealEstate.com](http://www.Sheffield-RealEstate.com)

Listing Agent:

E-Mail:

CalBRE:

**Wally Sheffield, Broker**

[sheffieldre@pacbell.net](mailto:sheffieldre@pacbell.net)

01329897

The information contained herein has been obtained from sources we deem reliable. We cannot, however, assume responsibility for its accuracy.